

OWAcoustic®
premium

OWAconstruct®



System S 3 bws
Ball impact resistant
With acoustic effect
Exposed grid





System S 3 bws

ball impact resistant, exposed grid

Technical Data

Product line:
OWAcoustic® premium

Patterns:
Constellation
Cosmos/N

Dimensions:
600 x 600 mm
625 x 625 mm

Thickness:
approx. 15 mm

Building class:
A2-s1,d0 to EN 13501-1

Edge detail: 3

Metal suspension:
All tees are galvanised with exposed surfaces painted white. **Only** s-system (click) suitable. For further details of sections, colours etc., please see OWA price list.

Suspension depth:
For ease of panel removal
≥ 230 mm recommended.

Fire resistance:
on request

Suspension system:

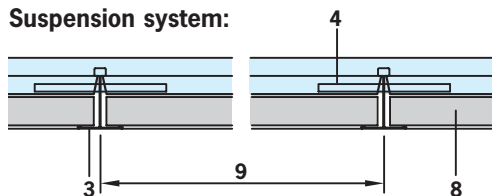

Cross section:

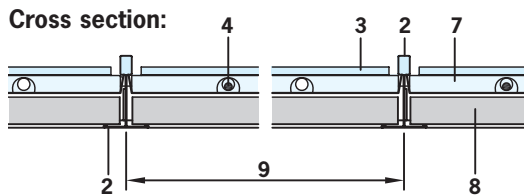

To avoid the notching of the perforated metal tile on-site it is recommended to set the Nonius hangers at the junctions of main and cross tees.

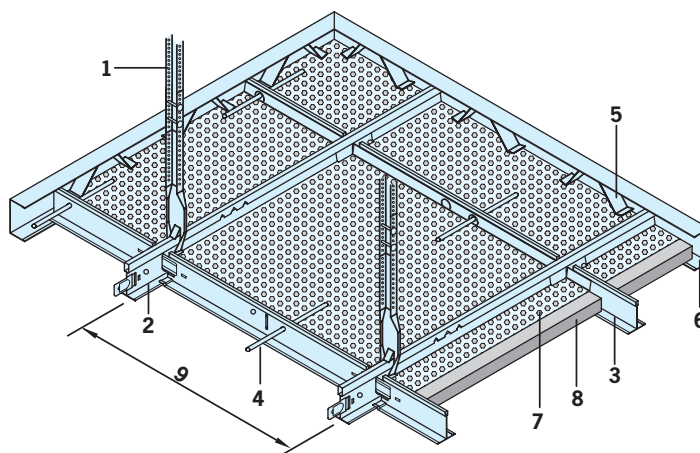

- 1 Nonius hanger No. 17/45 and Nonius hanger extension No. 16/... with 2 safety pins No. 76 or nail No. 78 per hanger, max. distance between centre ≤ 1250 mm
- 2 Main tee No. 45, max. distance between centre ≤ 625 mm
- 3 Cross tee No. 46 s
- 4 Suspension rod with eye No. 14/12/2
- 5 Wall spring clip No. 5210, every ≤ 312,5 mm
- 6 Perimeter trim No. 57
- 7 Perforated metal tile No. 5314X00001FF for grid 600 x 600 mm No. 5314X00001GG for grid 625 x 625 mm
- 8 OWAcoustic® premium tile
- 9 Module distance, ≤ 625 mm
- 10 Mineral wool overlay, depending on type

Section dimensions:

No. 45 No. 46 s

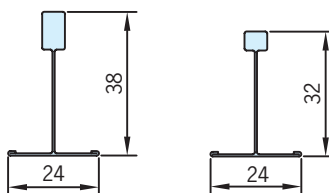

Construction:

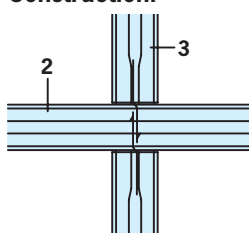

Cross tees (No. 46 s) have a connection tab on each end and these should be pushed into the selected slots of the main tees (No. 45). To ensure the cross tees are aligned, the adjacent cross tee must be put into the correct side of the same slot (see diagram). The ends of the main tees are joined by pushing the offset connectors together until they lock.



OWAcoustic®
premium

OWAconstruct®

System S 3 bws

ball impact resistant, exposed grid



Perimeter detail:

Wall spring clip No. 5210 is inserted every $\leq 312,5$ mm into perimeter trim No. 57. For further installation details see OWA installation guide 801.

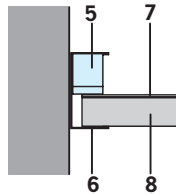

Connections to untested fittings must be of sliding design!

Installation examples:

Module 625 x 625 mm

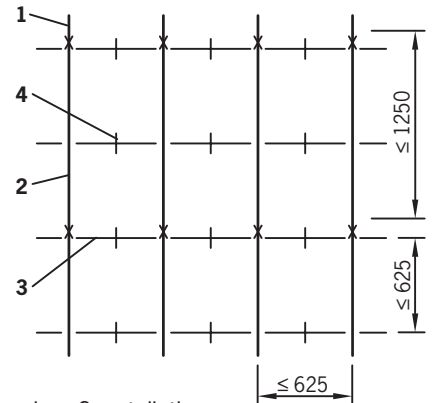

Sound absorption values:

Ball impact resistant ceiling with OWAcoustic® premium Constellation with perforated metal tile – suspension depth $H = 200$ mm

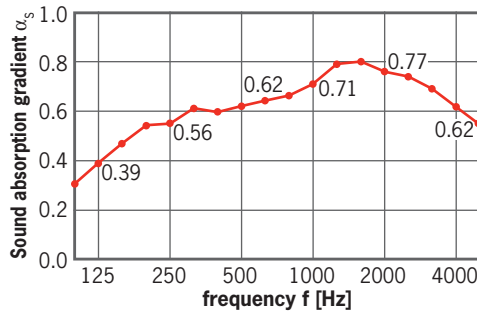

Average value: $\alpha_w = 0.70$ NRC = 0.65



Ball impact resistant ceiling with OWAcoustic® premium Constellation with perforated metal tile and 50 mm mineral wool overlay – suspension depth $H = 200$ mm

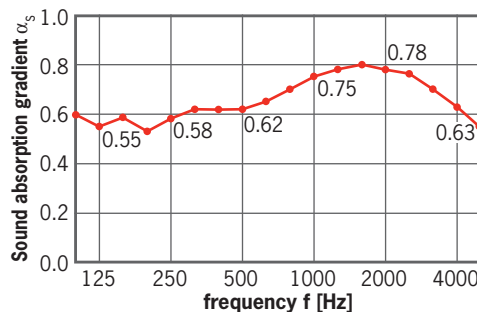

Average value: $\alpha_w = 0.75$ NRC = 0.70

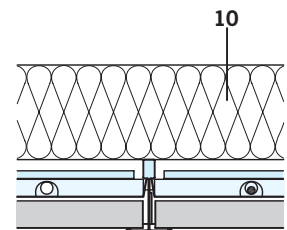

Accessories:

Lighting:

OWA-Prismat T 5 bws, No. 8114/3 E-bws, **exclusively** for format 600 x 600 mm
OWA-Lex bws, No. 8065/1 E-bws (EVG), **exclusively** for format 625 x 625 mm



Inspection hatches:

OWA inspection hatch with steel sheet lid, No. 8032-bws

OWAcoustic®
premium

OWAconstruct®

System S 3 bws

ball impact resistant, exposed grid

Material quantities per m² (Standard sizes):

No.	Description	600 x 600 mm	625 x 625 mm
17/45	Suspension	1.4 pce.	1.3 pce.
45	Main tee	1.66 m	1.6 m
46 s	Cross tee	1.66 m	1.6 m
14/12/2	Suspension rod with eye	2.8 pce.	2.6 pce.
5210	Wall spring clip	Dependent on room size and shape	
57	Perimeter trim		

Weight:

Suspension system approx.	1.70 kg/m ²	1.64 kg/m ²
Tile 15 mm, approx.	4.5 kg/m ²	4.5 kg/m ²
Perforated metal tile, approx.	3.84 kg/m ²	4.0 kg/m ²

For special situations, for example light fittings, see OWA installation guide No. 801.

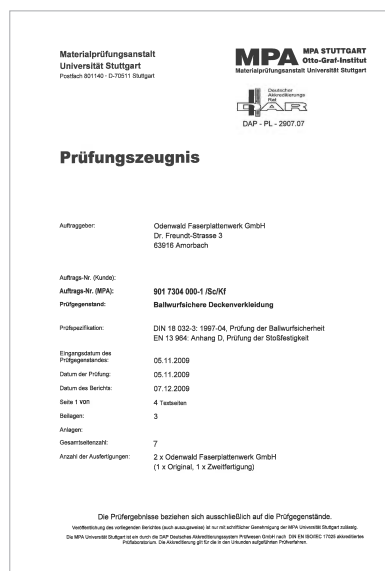

Test reports are available on request.

Ball impact test carried out in accordance with DIN 18032-3:1997-04, application area: ceiling; also tested in accordance with EN 13964, appendix D achieving Class 1A (impact speed 16.5 m/sec ± 0.8).

System description:

Exposed grid demountable OWAconstruct® System S 3 bws (Lay-in)

Quality Statement:

OWAcoustic® Mineral wool panels are free from harmful materials such as asbestos and formaldehyde. A statement from the German institute for Building Technology is available. The mineral wool used in these panels is biodegradable. The criteria of the zero-ranking as a carcinogenic material in the chemical prohibition ordinance (§ 1 appendix) section 23 bio-persistent fibres is complied with and therefore carries the "RAL-Seal of mineral wool" guarantees.

Construction description: In OWA System leaflet S 3 bws and OWA installation guide.

Construction components:

OWAconstruct® Nonius hanger No. 17/45
OWAconstruct® Main tee No. 45
OWAconstruct® Cross tee No. 46 s
OWAconstruct® Perimeter trim No. 57
OWAconstruct® Suspension rod with eye No. 14/12/2
OWAconstruct® Wall spring clip No. 5210
(System S 3 bws is only available as s-system)

Guarantee and liability

All system relevant data and statements correspond to the current technology. They assume the exclusive application of OWA products and system components, the interdependent behaviour of which is confirmed by internal and external testing. When they are used in combination with non OWA products and system components any warranties or guarantees are invalidated and liability will not be accepted. OWA reserves the right to make any technical alterations to improve either product or system development. **All goods are supplied in accordance with our general sale and delivery terms.**

OWA

Odenwald Faserplattenwerk GmbH
Dr.-F.-A.-Freundt-Straße 3
63916 Amorbach
Telefon: +49 9373 2 01-0
Telefax: +49 9373 2 01-1 30
www.owa.de · E-Mail: info@owa.de

Brochure S 3 bws/E
111002