



# REI 30, F 30 Gang-nailed trusses

System S 3, S 3a Contura, exposed, demountable.  
Cold roof, mineral wool insulation with vapour barrier



## Technical Data

**Product line:**  
OWAcoustic® premium

**Dimensions:**  
600 x 600 mm  
625 x 625 mm  
other sizes available  
on request

**Thickness:**  
approx. 15 mm

**Building class:**  
A2-s1,d0 to EN 13501-1

**Edges:**



**Suspension system:**  
All metal surfaces  
white painted, for further  
details and colours see  
OWA Price list

**Suspension depth a:**  
from back of OWAcoustic®  
tile to lower edge of  
gang-nail truss ≥ 150 mm

**Product line:**  
OWAcoustic® smart

**Dimensions:**  
600 x 600 mm  
625 x 625 mm  
other sizes available  
on request

**Thickness:**  
14 mm (nom.)

**Building class:**  
A2-s1,d0 to EN 13501-1

**Edges:**



**Suspension system:**  
All metal surfaces  
white painted, for further  
details and colours see  
OWA Price list

**Suspension depth a:**  
from back of OWAcoustic®  
tile to lower edge of  
gang-nail truss ≥ 250 mm

- 1 Hanger No. 12/.../2 (secure against displacement on site)
  - 2 Main runner section No. 45 at ≤ 1250 mm centres
  - 3 Cross tee No. 46
  - 4 Cross tee No. 47
  - 5 Perimeter trim No. 50 G, No. 50/15 G for edge 6 (premium) or No. 50/14 for edge 7 (smart)
  - 6 Fibre cement profiled sheets, bricks, tongued and grooved boards d ≥ 19.5 mm or chipboard d ≥ 16.0 mm
  - 7 Roof plate
  - 8 Timber gang-nailed truss
  - 9 Mineral wool insulation ≥ 140 mm between the trusses:
    - FLEXIROCK, Rockwool
    - Integra ZKF1-035
    - Insulation wedges, Rockwool
    - Metac UF, Isover
    - or -040, Isover
  - 10 Polyurethane sheet or alternatively OWAcoustic® premium tiles and mineral wool insulation encased with aluminium foil (Integra ZKF Rollisol, Isover)
  - 11 Timber batten 24 x 48 mm
  - 12 Timber batten ≥ 38 x 58 mm
  - 13 Half round wood screw 5.0 x 50 mm
  - 14 Fixing nail 5.0 x 50 mm or half round wood screw 5.0 x 50 mm
  - 15 Fixing nail 4.0 x 60 mm
  - 16 Fixing nail 3.1 x 90 mm
- > special fixing nail 3/C according to DIN 1052:2008-08, Para. 12.8.1 Table 14)

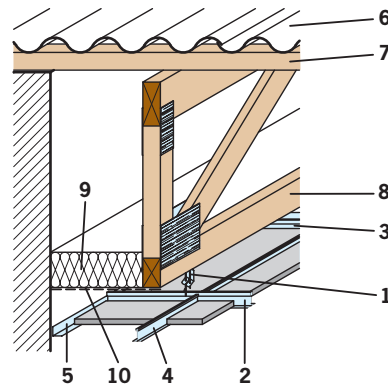

Section through the roof construction

Picture S 3

**1. Main runner sections at 1250 mm centres transverse to trusses**  
Hangers (1) secured to the underside of the trusses (8) at ≤ 1250 mm centres, ≥ 24 x 48 mm battens (11) fixed at ≤ 1000 mm centres to support the mineral wool insulation (9).

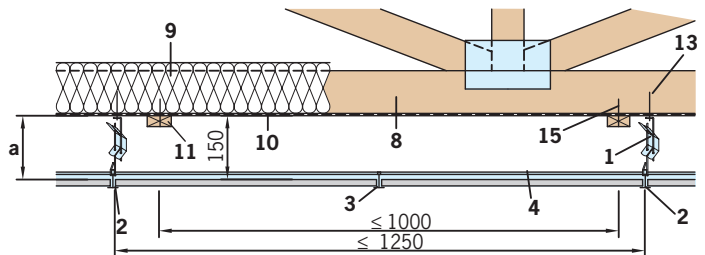

**2. Main runner sections at 1250 mm centres parallel to trusses**  
Hangers (1) secured to the side of the ≥ 35 x 38 mm battens (12), hangers and battens at ≤ 1250 mm centres, additional ≥ 24 x 48 mm battens (11) centrally positioned to support the mineral wool insulation (9).

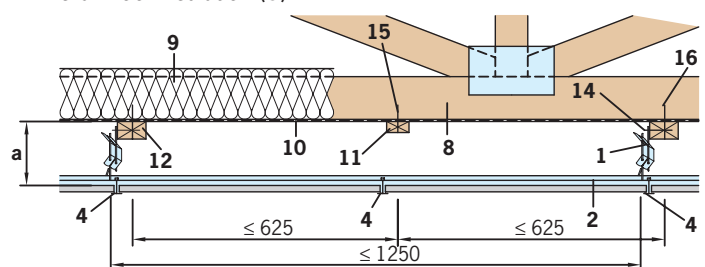

**3. Main runner sections at 1250 mm centres parallel to trusses**  
Hangers (1) secured to the side of the ≥ 35 x 38 mm battens (12), hangers and battens at ≤ 1000 mm centers.

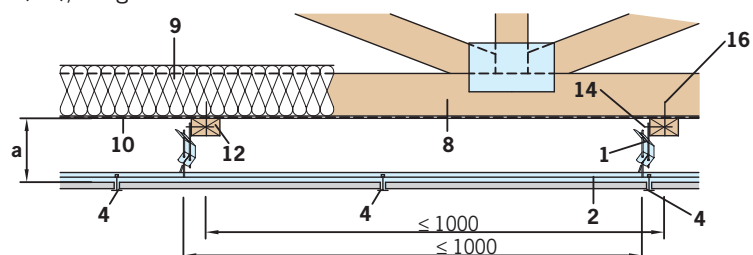



# REI 30, F 30 Gang-nailed trusses

System S 3, S 3a Contura, exposed, demountable.  
Cold roof, mineral wool insulation with vapour barrier

## Perimeter trims:

For other examples of perimeter trims and installation see OWA Installation guide 801.

System S 3

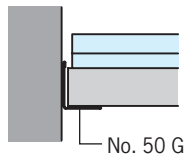

System S 3a

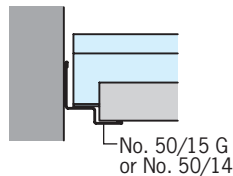

## Light fittings installation:

In principle, light fittings should be suspended either directly from the structure or be supported on the main tee sections with additional hangers positioned near each corner of the light fittings. They must also be protected by fire protection boxes. These are constructed from  $\geq 16$  mm thick Minowa® boards measuring approx. 1250 x 2500 mm which conforms to Building class A2-s1,d0. The fire boxes should be constructed in accordance with the assembly instructions delivered with the fire protection box sets, (see the information leaflet on fire protection boxes).

## System description:

### OWAcoustic® REI 30, F 30 Gang-nail trusses

OWAcoustic® Exposed grid system S 3/S 3a below timber gang-nail trusses F 30/REI 30 with glass wool, or mineral wool insulation  $\leq 140$  mm thick with OWAcoustic® premium, or OWAcoustic® smart ceiling tiles

### Roof construction:

The roof construction consists of timber gang-nail trusses, in conjunction with a glass or mineral wool insulation and a vapour barrier positioned between the trusses. Alternatively OWAcoustic® premium tiles can be used with an overlay of aluminium foil encased mineral wool such as Integra ZRF Rollisol, Isover.

## Material required per m<sup>2</sup> (Standard):

See System brochure S 3 and S 3a

No.	Description	625 x 625 mm
12/.../...	Hanger	0.7 pce
45	Main tee section	0.8 lm
46	Cross tee section	0.8 lm
47	Cross tee section	1.6 lm
50 G or 50/15 G E6 (premium) 50/14 E7 (smart)	Perimeter trim	Dependent on room size and shape

## Fire protection box – as per test report:

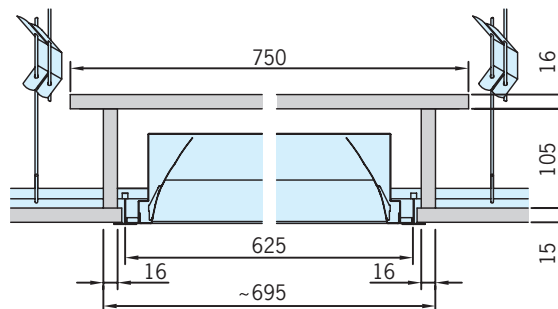

### 1. Main runner sections at 1250 mm centres transverse to trusses

Securing the hanger and spacing of the battens: Hangers (1) secured to the underside of the trusses (8) at  $\leq 1250$  mm centres,  $\geq 24 \times 48$  mm battens (11) fixed at  $\leq 1000$  mm centres to support the mineral wool insulation (9).

### 2. Main runner sections at 1250 mm centres parallel to trusses

Securing the hanger and spacing of the battens: Hangers (1) secured to the side of the  $\geq 35 \times 38$  mm battens (12), hangers and battens at  $\leq 1250$  mm centres, additional  $\geq 24 \times 48$  mm battens (11) centrally positioned to support the mineral wool insulation (9).

### 3. Main runner sections at 1250 mm centres parallel to trusses

Securing the hanger and spacing of the battens: Hangers (1) secured to the side of the  $\geq 35 \times 38$  mm battens (12), hangers and battens at  $\leq 1000$  mm centres.

## Guarantee and liability

All system-related data corresponds to the current state-of-the-art. They depend on the exclusive use of OWA products and system components, whose interdependent behaviour is confirmed by internal and external testing. When they are used in combination with non OWA products and system components, any warranty is invalidated. OWA reserves the right to make any technical alterations to improve either product or system development.



### Odenwald Faserplattenwerk GmbH

Dr.-F.-A.-Freundt-Straße 3  
63916 Amorbach  
Telefon: +49 9373 2 01-0  
Telefax: +49 93 73 2 01-1 30  
www.owa.de · E-Mail: info@owa.de

### OWA (UK) Ltd.

Unit 10, Perth Trading Estate  
Perth Avenue, Slough SL1 4XX  
Tel.: +44 1753 55 24 89  
Fax: +44 1753 52 60 60  
www.owa-ceilings.co.uk  
E-Mail: sales@owa-ceilings.co.uk